

OWNER'S MANUAL

ENFORCER[®]

300C

300L

(315 MHz)

•

300C - 4

•

300L - 4

(433.92 MHz)

Remote Controlled
Vehicle Security System
with Shock and Glass-Break Sensors

SLI[®]

SECO-LARM[®] U.S.A., INC.

16842 Millikan Avenue
Irvine, California 92606

CONGRATULATIONS

From the moment you purchased this ENFORCER Vehicle Security System, you became a part of the SECO-LARM family. You started taking advantage of over 31 years of advanced engineering. You joined a team of engineers, technicians, designers, and people like yourself who know how important protecting your car is. You discovered the SECO-LARM difference.

This difference is important because the ENFORCER is more than just an alarm. It is a complete security and convenience system. It is like having your personal security guard and butler on call in your car, 24 hours a day.

Keep in mind that the best security systems will not work properly without careful installation. Therefore, the ENFORCER is designed for installation by your professional SECO-LARM dealer. He understands both his alarms and your needs, and will work hard to ensure the ENFORCER does its job for you. Welcome to the family: SECO-LARM, your dealer, and you!

IMPORTANT

This ENFORCER security system contains many innovative features and unique functions. Please read this Owner's Manual carefully in order to understand all of this alarm's security and convenience features. Some features may require the addition of sensors or accessories not included with this alarm. Please consult your professional SECO-LARM dealer.

NOTICE

The information and specifications printed in this manual are current at the time of publication. However, the SECO-LARM policy is one of continual development and improvement. For this reason, SECO-LARM reserves the right to change specifications without notice. SECO-LARM is also not responsible for misprints or typographical errors.

Copyright © 2001 SECO-LARM® U.S.A., Inc. All rights reserved. This material may not be reproduced or copied, in whole or in part, without the written permission of SECO-LARM. This vehicle security system is protected by patents in the U.S.A., Great Britain, Germany, Hungary, Taiwan, China, Japan, and Korea. Other U.S.A. and international patents are pending.

INSTRUCTIONS TO THE USER

This equipment has been tested and found to comply with the limits for a class B digital device, pursuant to part 15 of the FCC Rules. These limits are designed to provide reasonable protection against harmful interference in a residential installation. This equipment generates, uses and can radiate radio frequency energy and if not installed and used in accordance with the instructions, may cause harmful interference to radio communications. However, there is no guarantee that interference will not occur in a particular installation. If this equipment does cause harmful interference to radio or television reception, which can be determined by turning the equipment off and on, the user is encouraged to try to correct the interference by one of more of the following measures:

- * Reorient or relocate the receiving antenna.
- * Increase the separation between the equipment and receiver.
- * Connect the equipment into an outlet on a circuit different from that to which the receiver is connected.
- * Consult the dealer or an experienced radio/TV technician for help.

This equipment has been certified to comply with the limits for a class B computing device, pursuant to FCC Rules. In order to maintain compliance with FCC regulations, shielded cables must be used with this equipment. Operation with non-approved equipment or unshielded cables is likely to result in interference to radio and TV reception. The user is cautioned that changes and modifications made to the equipment without the approval of manufacturer could void the user's authority to operate this equipment.

This device complies with FCC Rules Part 15. Operation is subject to the following two conditions: (1) This device may not cause harmful interference, and (2) this device must accept any interference that may be received, including interference that may cause undesired operation.

TABLE OF CONTENTS

Transmitter Functions	3	Starter Disable	9
Arming	4	2nd and 3rd Channel Outputs	9
Armed	5	Power Door Locks	9
Zone Bypass	5	Domelight Supervision	10
Sensor Bypass	5	Tamper Indicator	10
Emergency Call for Help (Panic)	5	Second Car Operation	10
Total Protection	6	Dual Power Protection (DPP™)	10
Disarming	6	Appendix 1 Programed Features	10
Stay Safe Disarm	7	Appendix 2 Understanding the Siren Chirps & Light Flashes	11
Emergency Disarm	7	Appendix 3 Understanding the LED Flashes	11
Chirp Delete (Silent arm/disarm)	7	Accessories	12
Valet Mode	8		
Dual stage Shock Sensor	8		
Dual stage Glass break Sensor	8		

TRANSMITTER FUNCTIONS

1. Press transmitter button #1 to:
 - Arm and disarm the alarm.
 - Turn the siren on (and shut it off) in an emergency.
 - Lock/unlock power door locks.
 - Bypass an open trigger zone.
2. Press transmitter button #2 to:
 - Operate channel 2 (such as popping the trunk or rolling up the windows).
 - Silently arm or disarm the alarm.
 - Operate second vehicle.
 - Bypass the alarm sensor's pre intrusion function.
3. Press transmitter button #3 to operate channel 3 (for instance, to remote start the engine).

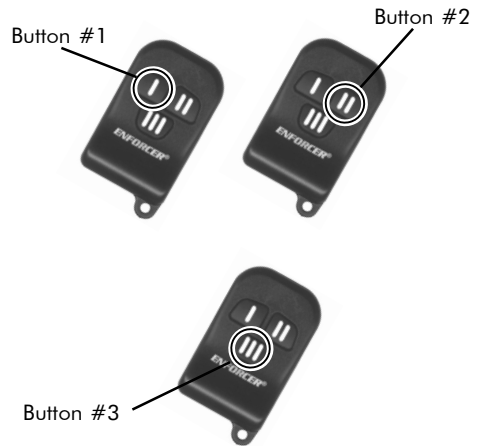

These features and functions are explained in this Owner's Manual.

ARMING

There are two different ways to arm your alarm. Tell your dealer which is best for you:

❑ Active Arming

Turn your ignition off. Close all the doors. Then press transmitter button #1. If the siren chirps and parking lights flash once, the alarm is fully armed.



If the siren chirps and parking lights flash three times, the alarm is either waiting for the vehicle's delayed domelights to turn off (if your vehicle is so equipped), or it is telling you that one of the alarm's zones (a door, or the hood or trunk) is either open or is not functioning properly (see ZONE BYPASS, page 5). Also, check to make sure your car's domelight switch was not accidentally left on.

❑ Passive Arming

Turn the ignition off, and open a door to exit the car. When the last door is closed (and the domelights turn off, if your car has delayed domelights), the siren chirps and the parking lights flash once. The LED now flashes quickly during the 30 second arming countdown, after which the siren chirps and parking lights flash once more to confirm the alarm is completely armed.

If you wish, you can open a door during the 30 second arming countdown, and keep it open for as long as needed. The LED turns off while the door is opened. When finished, once again close all the doors. The siren will chirp and the parking lights will flash once, and the LED will flash quickly to show the 30 second arming countdown has restarted.

If you close the last open door, and the siren does not chirp and parking lights do not

flash, you know that one or more openings are not closed properly. This is SECO LARM's patented Quick and Quiet Testing (Q.Q.T.[™]), and it prevents you from thinking your alarm is armed when it may not be. In such a case, make sure all the doors, as well as the hood and trunk, are closed properly, and that your vehicle's domelights are off. If you cannot locate the problem, but need to arm the alarm, then press button #1 to immediately arm the alarm and bypass whatever zone is open (see ZONE BYPASS, page 5).

❑ One-Time Override of Passive Arming

This function can prevent the alarm from arming one time if it is programmed for passive arming. This is useful for leaving the car for a short period of time such as when you stop at a gas station and you have friends that are going to wait in the car. To operate, turn off the ignition and press the VELT button once before opening any door (the LED will then turn steady on until the ignition is turned on or transmitter button is pressed). If you change your mind and wish to leave the car for an extended time, press transmitter button #1 to arm the alarm. The one time override feature is automatically disengaged once the ignition is turned on.

NOTE Under passive arming, you can force your alarm to arm immediately any time during the 30 second arming countdown by pressing transmitter button #1.

NOTE There are references to opening or closing a door throughout this manual. The term "door" also includes your hood and trunk, if they are protected. Ask your dealer.

ARMED

When the 30 sec. arming countdown ends, or when transmitter button #1 is pressed to arm the alarm, the siren chirps and parking lights

flash once, and the LED starts flashing to show the alarm is armed.



ZONE BYPASS

When you press button #1 to arm the alarm, and the alarm responds with three chirps and three light flashes, there are two possibilities:

- A. Delayed domelights If your domelights do not immediately turn off when you close your car door (in other words, your vehicle has delayed domelights), this is normal. The alarm should protect all the openings once the domelights go off.
- B. A zone was bypassed In other words, the alarm has armed, but a hard wired door is not protected (either because it is open, or because its pin switch is broken).

If the bypassed door is later closed, it will be restored (no siren chirp or light flash).

If your alarm indicates a bypassed zone, find the cause as soon as possible to ensure your vehicle is completely protected. For instance, if your driver's door is not properly closed when you arm your alarm, a thief could open any door without setting off the alarm.

NOTE The three zone bypass confirm chirps will not sound if chirp delete is engaged. However, the parking lights will still flash three times. See CHIRP DELETE, page 7.

SENSOR BYPASS

This is useful if you know, based on experience, that your shock, glass break, or other add on sensor will false trigger, such as when you park near a construction site.

To bypass your alarm's sensors, first press button #1 to arm the alarm (even if the alarm is set for passive arming). The siren chirps and the parking lights flash once (three times if a zone is bypassed) to confirm armed. Within three seconds, press button #2. The



siren chirps three times and the parking lights flash three times to confirm sensors are bypassed. The sensors are automatically restored the next time button #1 is pressed.

EMERGENCY CALL FOR HELP (Panic)

To trigger the alarm in an emergency (armed or disarmed), press and hold transmitter button #1 for 3 seconds. The siren sounds and the parking lights flash about 30 seconds. You can also stop the siren and the

parking lights by pressing button #1 again. When panic is activated, the alarm will disarm and doors will unlock (if remote controlled door locks are connected).



TOTAL PROTECTION

While your alarm is armed, your car is protected in the following ways:

- Potential thieves or vandals will be deterred by the flashing LED.
- If a thief opens a door, the alarm immediately sounds the siren and flashes the parking lights for 30 seconds. If the opened door is not closed and current sensing has not been selected, the siren and lights will trigger up to four 30 sec. cycles, after which the alarm will rearm.
- Turning the ignition key on will trigger the alarm for 30 seconds.
- The starter disable prevents the engine from being started.
- If the shock sensor detects light taps on the car, it will trigger the pre intrusion alert (the siren chirps five times and the parking lights flash five times) to warn potential thieves and vandals. However, if it detects a strong shock to the car, such as shock caused by prying the trunk open, it will trigger the alarm for 30 seconds. (See DUAL STAGE SHOCK SENSOR, page 8.)
- If the built in glass break sensor detects light taps to the window, it will trigger the pre intrusion alert. However, if a window is broken, or is hit hard with a metal object, it will trigger the alarm. (See DUAL STAGE GLASS BREAK SENSOR, page 8.)
- Optional SECO LARM shock, motion, glass break, and microwave sensors will offer your alarm additional protection. Ask your SECO LARM dealer.

DISARMING

To disarm the alarm, press button #1. The siren chirps twice, the parking lights flash twice, and the LED turns off. What happens next depends on how your alarm is set (ask your dealer):

- ☐ **Alarm set for active arming:**
The alarm is now completely disarmed.
- ☐ **Alarm set for passive arming:**
 - A. A 30 second automatic rearming period begins.
 - B. Open a door and turn the ignition on before the rearming period expires to completely disarm the alarm.
 - C. If you do not turn the ignition on in 30 seconds, the alarm rearms, the siren chirps and parking lights flash once, and the LED starts flashing.



NOTE Under passive arming, the LED flashes quickly from the time button #1 is pressed to disarm the alarm until the alarm is either completely disarmed or it rearms. The LED turns off while a door is open (if connected to door switch).

NOTE If passive arming is used, the alarm can be forced to remain disarmed if needed. See "One Time Override of Passive Arming" on page 4.

PATENTED STAY-SAFE DISARM™

Any time your alarm is triggered (the siren is sounding and the parking lights are flashing), press transmitter button #1 once to shut the siren and flashing parking lights OFF while the alarm stays completely armed.

NOTE If a door was open when you pressed transmitter button #1, the siren chirps three times and the parking lights flash three times to confirm it is not protected (see ZONE BYPASS, page 5).

EMERGENCY DISARM

If you lose your transmitter, you can disarm your alarm with the ignition key and VELT button. While your alarm is either armed or triggered, turn the ignition switch on, then press and release the VELT button once. The siren and the flashing lights stop, and the alarm is disarmed. (Ask your dealer where the VELT button is hidden.)

NOTE If you use emergency disarm, the alarm will arm passively when you turn the ignition off and close the doors. Next time you open a door, you will have 10 seconds to turn the ignition on and press the VELT button to disarm the alarm before the siren sounds. This delay is cancelled next time you arm or disarm your alarm with the transmitter.



CHIRP DELETE (Silent arm/disarm)

There are times, especially late at night, when you may not want to hear the siren chirps. There are two ways to delete the chirps:

- A. **One-time delete** Press button #2 any time before you press button #1, and the chirps will not sound when you press button #1. For instance, if you press button #2 before button #1 to arm or disarm the alarm, the chirps will not sound, but the parking lights will flash. The chirps sound the next time you press either button.



- B. **Permanent delete** Your dealer can program your alarm to delete the chirps.

NOTE Either method deletes the arm, disarm, pre intrusion, zone bypass, and valet chirps. However, it does not affect the flashing parking lights.

VALET MODE (Passive arming only)

If your alarm is set for passive arming and you do not want it to arm automatically when you leave your car, you can put it in the valet mode. For instance, you may not want the alarm to arm when you leave your vehicle to be serviced or for valet parking.

To enter valet, first disarm the alarm, close all doors, turn the ignition ON, and press and release the VELT button once. The siren chirps once to confirm the alarm is in valet.

To exit valet, close all doors, turn the ignition ON, and press and release the VELT button once. The siren chirps twice to confirm valet is exited and the alarm is now disarmed.

While your alarm is in valet, the LED flashes slowly so thieves think the alarm is armed. If you press transmitter button #1 while the alarm is in valet, the doors will lock or unlock, and the parking lights will flash four times.



NOTE If you trigger the alarm by doing emergency call for help (panic) while the alarm is in valet, the alarm will exit valet.

DUAL-STAGE SHOCK SENSOR

Your alarm includes a patented dual stage shock sensor.

The first stage (pre intrusion alert) warns thieves the alarm is armed. For instance, the alarm will chirp five times and the parking lights will flash five times if the shock sensor detects a light bump to the vehicle. However,

if the thief attacks the car with sufficient force, the alarm will trigger. (Your dealer can make the shock sensor more or less sensitive to attack, depending on your vehicle.)

NOTE The shock sensor will not be ready to trigger the alarm until four seconds after the alarm is armed.

DUAL-STAGE GLASS-BREAK SENSOR

Your alarm also includes a built in, patented sensor to detect the sound of glass breaking.

The first stage (pre intrusion alert) warns thieves the alarm is armed. For instance, the alarm will chirp five times and the parking lights will flash five times if the glass break sensor detects tapping on the windows. However, if the thief attacks the car with

sufficient force, the alarm will trigger. (Your dealer can make the sensor more or less sensitive to attack, depending on your vehicle.)

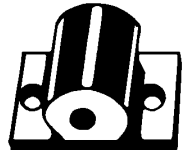

NOTE The glass break sensor will not be ready to trigger the alarm until four seconds after the alarm is armed.

STARTER DISABLE

With this optional feature, while your alarm is armed, your car will not start, even if a thief has your keys.

Your alarm also has Automatic Starter Disable (ASD). ASD works as follows:

- If your alarm is set for active arming, and you do not arm it, ASD automatically disables your engine's starter 10 minutes after you disarmed the alarm or turned the ignition switch off. The LED stays on constantly to show ASD is engaged.
- Once ASD is engaged, you must press transmitter button #1 to disengage ASD before the engine will start.
- If you press transmitter button #1 to disarm the alarm, but do not open the door, ASD will re engage 30 seconds later.
- If you press transmitter button #1 to disarm the alarm, then open the door and close the door without turning the ignition on, ASD will re engage 30 seconds later.

ASD is programmable ask your dealer.

2nd & 3rd CHANNEL OUTPUTS

Your transmitter has two extra channels to control optional accessories:

- A. **2nd channel** is commonly used to "pop" the trunk. To use, press transmitter button #2 for 3 seconds, either while the ignition is on and any door is opened, or while the ignition is off. (Note If no doors are hardwired to your alarm, 2nd channel will not operate with the ignition on. Ask your



dealer for details.)

- B. **3rd channel** is commonly used for optional remote car starting. Press button #3 for as long as needed.



POWER DOOR LOCKS

With this optional feature, your alarm can lock the doors when it is armed and unlock them when it is disarmed. They can be set to lock and unlock any time transmitter button #1 is pressed, or when the last door is closed for passive arming. They lock automatically if the alarm is triggered (exception see EMERGENCY CALL FOR HELP, page 5).

Ignition-controlled operation The doors automatically lock when you turn the ignition on, and unlock when you turn the ignition off. (Programmable ask your dealer).

2-step unlock When your alarm is armed, pressing button #1 disarms the alarm and unlocks the driver's door only. Pressing the button again within one second unlocks the passenger doors without arming the alarm. (Optional ask your dealer.)

Auto locking with passive arming The doors can be set to automatically lock after the 30 second exit delay is over and the alarm arms. (Programmable ask your dealer.)

DOMELIGHT SUPERVISION

Whenever you disarm the alarm, your car's domelights turn on for 30 seconds to help

you find your car at night and make sure no one is hiding inside.

TAMPER INDICATOR

If your alarm was triggered when you were away, the siren will chirp two times and the parking lights flash seven times when you disarm your alarm.

These "memory" flashes automatically reset when the ignition is turned on.

SECOND CAR OPERATION

With this feature, your transmitters can control alarms in two cars, with the functions of

button #1 and button #2 switched in the second car. (Optional ask your dealer.)

DUAL-POWER PROTECTION (DPP™)

Helps keep your alarm powered even if a thief cuts the alarm's main power line.

(Optional ask your dealer.)

Appendix 1 — PROGRAMMABLE FEATURES

Programmable features allow you to customize your alarm. Your dealer can program them when the alarm is installed.

- **Passive/active arming** In passive arming, the alarm arms itself when you turn the ignition OFF and close the last open door. In active arming, press transmitter button #1 to arm the alarm.
- **Manual/auto door locks in passive arming mode** If your alarm is set for passive arming, it can be set to lock the doors automatically when it arms (don't forget to take your keys!). Otherwise, you must press transmitter button #1 to lock the doors.
- **Ignition-controlled door locks** The doors can be set to automatically lock/unlock when ignition is turned ON/OFF.
- **Permanent chirp delete** Permanently enables or disables the siren's chirps.
- **Automatic Starter Disable (ASD™)** Enables or disables ASD. With ASD, if used, 10 minutes after you turn the ignition off, the alarm disables your engine's starter even if you forget to arm your alarm!

Appendix 2 — UNDERSTANDING THE SIREN CHIRPS AND LIGHT FLASHES

- A. **1 chirp** Valet mode & learning mode is successfully entered.
- B. **1 chirp/flash:**
- When transmitter button #1 is pressed, the alarm is armed.
 - When a door is closed, the alarm will arm in 30 sec. (passive arming).
 - 30 sec. after ignition switch is turned OFF and all doors are closed (or 30 seconds after delayed domelights turn OFF), the alarm is armed (passive arming with switch sensing).
- C. **2 chirps** Valet mode & learning mode is successfully exited.
- D. **2 chirps/flashes** When transmitter button #1 is pressed, the alarm is disarmed.
- E. **3 chirps/flashes** When pressing transmitter button #1 to arm the alarm, indicates the alarm arms even though it is not set properly (door not closed, or broken switch, or domelight is still on, see ZONE BYPASS on page 5).
- F. **3 flashes** When pressing transmitter button #1 then button #2, indicates sensor's pre intrusion function is bypassed.
- G. **4 flashes** When transmitter button #1 is pressed, indicates alarm in valet.
- H. **5 chirps/flashes** Pre intrusion warns potential thieves or vandals who trigger the first stage of a dual stage shock or glass break sensor that your car is protected by an alarm.
- I. **7 flashes** When the alarm is disarmed, indicates the alarm was triggered while you were away.
- NOTE The chirps for arm, disarm, pre intrusion, zone bypass, and valet can be deleted (see CHIRP DELETE, page 7).

Appendix 3 — UNDERSTANDING THE LED FLASHES

- A. **Arming indicator** Flashes quickly during the 30 second rearm or passive arming countdown.
- B. **Door open indicator** Off when a hard wired door is opened during the 30 second rearm or passive arming countdown.
- C. **Armed indicator** Flashes when the alarm is armed.
- D. **Disarmed indicator** Off when the alarm is disarmed.
- E. **One-time override of passive arming** Steady on after VELT button is pressed once.
- F. **RF reception indicator** On while any transmitter button is being pressed.
- G. **Valet mode indicator** Flashes slowly 1.5 sec ON, 0.5 sec OFF.
- H. **Immobilizer mode indicator** Flashes fast, 0.5 sec ON, 1.5 sec OFF.

Don't forget the **ACCESSORIES!**



E-300L :SK-919T3J E-300C :SK-917T3J
E-300L-4 :SK-939TS3J E-300C-4 :SK-937TS3J
Spare transmitter — Get one for everyone who drives the car (2 included with alarm)

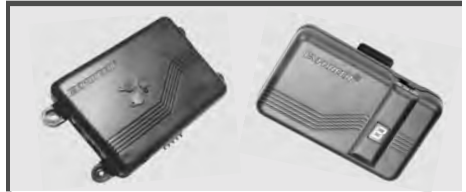

SECOPAGE® 35E
Vehicle security pager pages you if your car is broken into



SR-5240 or SR-5440A
Window roll-up modules for 2-door or 4-door cars



SR-5202 or SR-5204
Complete 2-door and 4-door lock kits for cars without power door locks



SS-051ME
Glass-break sensor — Detects the high-frequency sound of glass breaking

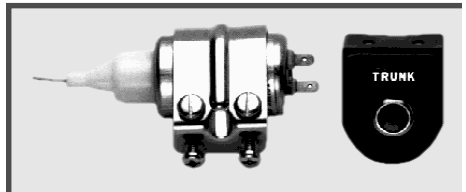

SR-5911
Power trunk release — Adds convenience to cars without power trunk release



SLI® 259A
Dual-stage microwave sensor — Detects movement inside car and protects open-top vehicles

Make your alarm YOUR alarm!

Your dealer has a wide variety of other accessories which can increase your alarm's security and convenience. Ask for more information. And insist on **GENUINE SECO-LARM** accessories!

NOTE — The accessories on this page are optional.